

Quote Request Form

Project Name _____

Customer Name _____

Customer Address _____

Phone _____

Fax _____

E-Mail _____

How did you hear about us? Please be as specific as possible.

Project Timeline _____

Project Type Residential - New Residential - Remodel

Commercial - New Commercial - Remodel

Railing Infill Options

- 1/8" Horizontal Cable
- 1/8" Vertical Cable
- Glass
- Picket

Post Attachment Options

- Surface (Base) Mount
- Fascia Mount
- Fascia Bracket Mount
- Stanchion Mount
- Core Mount

Drawings/Documents (If Required)

- Project Specific Submittal Drawings
- Project Specific Structural Engineering

Railing Height

- 36"
- 38"
- 42"
- Custom

Mounting Surface

- Concrete Slab
- Wood
- Composite over Wood
- Other

Project Location

- Inland
- Coastal (Salt Water) Distance from water _____

Foot Rail

- Yes
- No

Deck Fascia Size

- 2" x 6"
- 2" x 8"
- 2" x 10"
- 2" x 12"

Accessories

- LED Lights
- Can Lights
- Single Gate
- Double Gate
- Applied Grab Rail
- Grommeted Posts

Foot Rail Bottom Cover

- Yes
- No

Price quotes take 3-4 days, and final orders take 4-5 weeks for delivery.

Phone: 800-624-1116

Fax: 714-545-3311

Email: sales@usrigging.com

Cap Rail Options

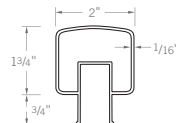

Series 100 Cap

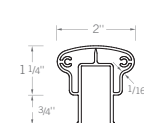

Series 150 Cap
(Graspable design for stairs)

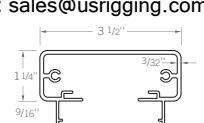

Series 200 Cap

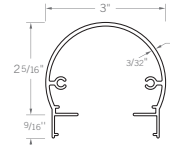

Series 300 Cap

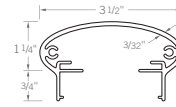

Series 350 Cap

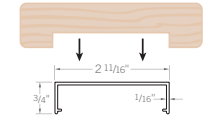

Series 400 Cap

Color Options (Representation only)

- White
- Green
- Gray
- Cream
- Taupe
- Bronze Matte
- Silver
- Black Matte

Standard Posts

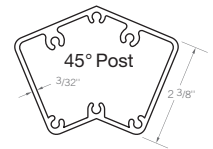
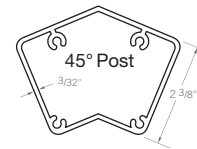
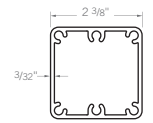
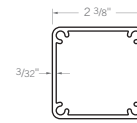

Sketch Area